

ALBA S.r.l.
19/02/2020
mg

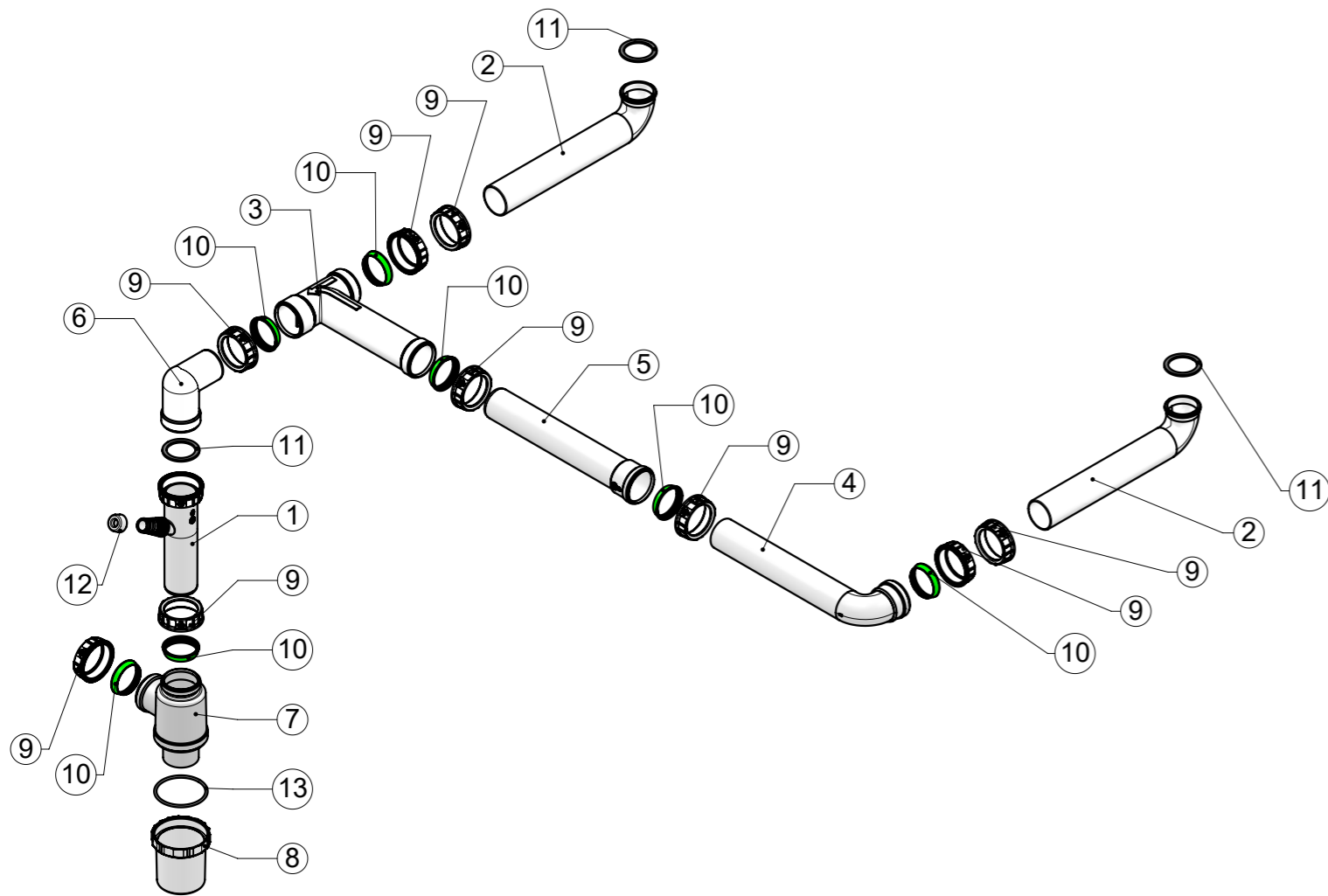

Bill of materials

Pos.	Drawing	Code	Q.ty	Denomination	Material	Colour
1	00274	AB0CA0506R	1	Assembled adjustable pipe with nut		White
2	00112	AB0ST0038R	2	L pipe connection DN40 L.245 with flat	PP	White
3	00707	AB0ST0174R	1	T-fitting D40x103x175	PP	White
4	00113	AB0ST0036R	1	L pipe connection DN40 L.245 1-1/2" thread chamfer	PP	White
5	01307	AB0ST0213R	1	Pipe DN40 male-female 1-1/2" L.250	PP	White
6	00001	AB0ST0162R	1	L fitting DN40 thread with flat	PP	White
7	00273	AB0ST0058R	1	Siphon body DN40		White
8	00297	AB0ST0005R	1	Bowl S.1000	PP	White
9	00005	AB0ST0068R	9	Open nut G 1-1/2"	PP	White
10	00064	AB0ST0092R	7	Conical washer DN40 plastic	PE LD GR70	Green
11	00133	AB0AQ0115R	3	Flat gasket 1-1/2" DN40 sp.2	PVC 70Sh	Grey
12	00348	AB0AQ0211R	1	Stopper for washing-machine pipe	PVC 70Sh	White
13	00415	AB0AQ0090R	1	O-Ring 059,00X065,00X3,00	PVC 70 Sh	Black
14	05600	AB0ZZ1789R	1	Assembling instructions for 61001104		
15	00895	FITP00004	1	Plastic bag	PE LD	
16	00886	AB0ZZ0754R	1	Label 80X80 61001104		

	Date	Signature	Customer code 61001104
	Drawn	08/06/2016	
	Approved	15/06/2016	PASINI
mm	Critical dimension or feature	General tolerance UNI EN 22768 m L	Scale 1:8 (A3)
Connection kit 2W 61001104			Drawing No 05598
		Code AB0011150R	Revision 00